

Kaylynnne Homes Presents

# HARVESTER CREEK

STARTING IN THE LOW \$500'S

Nestled among tall cedar trees, Harvester Creek is conveniently located in Cedar Hills just minutes from Hwy. 26. 4 & 5 bedrooms, mini-suites with bathrooms, large hobby/laundry rooms, butlers pantries & mud rooms. Stainless steel appliances, granite island counters and walk-in closets in all bedrooms. So many wonderful amenities to list!!

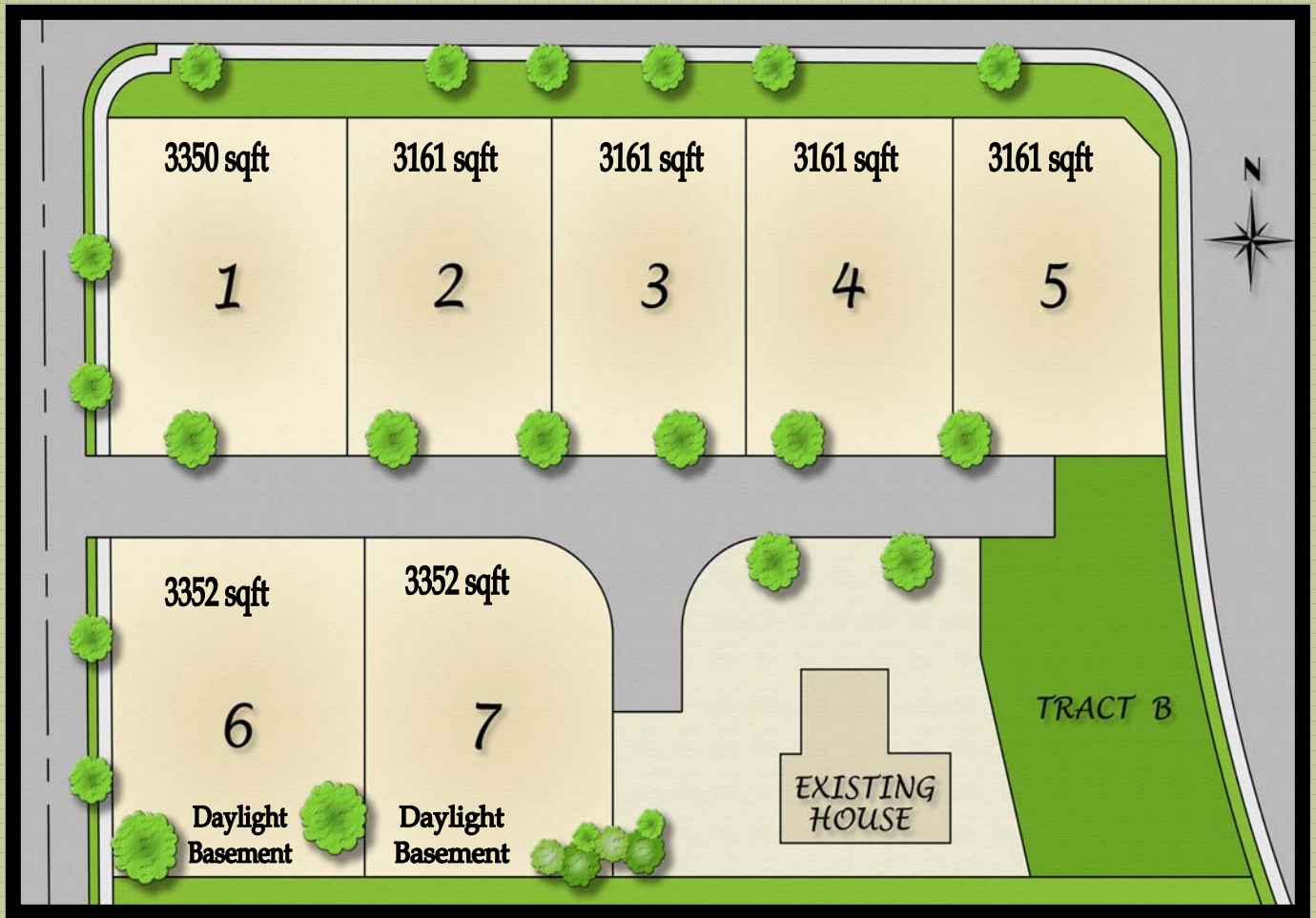

Photos and drawings are for illustration purposes only. Prices, availability and floor plans are subject to change without notice.



[www.crandallgroup.com](http://www.crandallgroup.com)



REAL ESTATE MARKETING & SALES,  
ACQUISITION & DEVELOPMENT

Christine Nickerson

503-810-2732

John L. Scott | REAL ESTATE [christinen@crandallgroup.com](mailto:christinen@crandallgroup.com)

Map not to scale.